

1516 Main Street, Suite A.  
Susanville, CA 96130  
(530)260-0067

[www.honeylakevalleyrcd.us](http://www.honeylakevalleyrcd.us)

## BID PROSPECTUS

**Treatment Methods:** The White Project is a post fire restoration project which aims to remove or alter the composition of burnt vegetation on ~40 acres of forest owned by one private nonindustrial forest landowners. Project site burned in the Sheep Fire (2020). The project objectives are to substantially reduce or eliminate the threat of fire-killed trees within the project boundary. This project is organized by the Honey Lake Valley Resource Conservation District and funded through a grant through USFS.

### Scope of Work:

- Felling: hand fell and/or mechanical fell (feller buncher) all standing fire killed trees > 4-inch DBH.
- Dead and down trees will also be removed.
- Skidding/Bunching: skid all felled woody material by skidder or tractor to landing or tractor pile in unit - preference will be to skid felled material to landing.
- Locations of tractor-piling shall be as agreed with the RPF.
- Disposal: decked material in landing will be chipped and removed from the site, or masticated, or a combination thereof upon agreement of RPF and the District.
- RPF and LTO shall agree upon and flag landing locations. Following biomass removal, landing location shall be recontoured and installed with erosion control structures, as necessary
- Slash debris shall not exceed 20 inches resting height above the ground. Scattered pieces may be left for soil cover and wildlife needs.
- Stump heights shall not exceed 10" on the uphill side.
- The project will involve the installation of a temporary road crossing on a fish bearing Class I watercourse. The crossing location has gentle side slopes and was historically used as a crossing location for timber operations. The installation will be covered utilizing a 1600 agreement that will be issued by California Department of Fish and Wildlife. It will not be the responsibility of the LTO to obtain the permit however the LTO would be subject to inspection at any point during installation or use and upon removal. The crossing will consist of installing two 36" CMP's (Corrugated Metal Pipe) each 20' in length that are on the property and will need to be moved to the crossing location. Additionally, it is anticipated that an additional 4 pipes will need to be provided by the contractor to be placed adjacent to the 36" CMP and will need to be 12-18" in diameter and approximately 16-20' in length. The contractor shall include in their bid price the placement of clean crushed rock 1-2" rock size to be used as fill and on the crossing approaches with an estimated volume of 75 yards. Upon completion of use the contractor

will be required to pull the crossing and install drainage control (waterbars) on both approaches and treat the road surface with either and or the rock from the crossing or straw for a distance of approximately 75' in either direction.

The two 36" culverts will be left on site for landowners.

- Roads used for commercial haul will be satisfactorily treated for dust abatement under dry road conditions.

**Sale of Logs and Chips:** Legal ownership and title of merchantable usable wood fiber material resulting from the project shall be vested with the Contractor. The Contractor may sell or arrange for the purchase of wood fiber (saw logs, biomass chips, and/or firewood) removed from the property. The successful proposer/s may remove material to chip or biomass facilities, provided there is agreement and approval by HLVRCD on accountability procedures commonly used such as third-party scalers or weight scales.

Anticipated revenue from chips should be reflected in the bidders price/ unit. The Contractor will be responsible for the California Timber Yield Tax, if/when any wood fiber is sold. Load receipts and sequentially-numbered trip tickets will be submitted to HLVRCD as proof of delivery.

Funding for this project comes from the United States Forest Service State and Private Forestry grant program. The grant program is a non-commercial grant program, and all revenue earned through sales of logs and chips must be used to defray the costs of operations (i.e., contractor will receive and retain delivered log values to defray costs of operation).

**Payment:** Contractors may submit invoices no more frequently than once per month. Payment will be made within 60 days of invoice receipt or upon project completion, whichever occurs later, provided that all work has been reviewed and approved by HLVRCD and/or RPF.

**Location:** The project is located southeast of the community of Susanville, in Township 29 North, Range 11 East, portions of Sections 07 Mount Diablo Base and Meridian (MDBM) in Lassen County, California. Access is available from Highway 36.

**Bid Tour Date :** April 21st 2026 at Willard Creek Road at 2 pm (40.390424, -120.788753). If the date of the bid tour is a time unavailable to you, and you are interested in arranging an alternative time for a site visit, please email [postfire@honeylakevalleyrcd.us](mailto:postfire@honeylakevalleyrcd.us) or call 530-260-642.

**Bids :** Emailed or hand delivered bids for contractor services will be received at any time and preferably no later than April,30th 2026 at 5 pm. HLVRCD will not accept bids past this deadline. Bids should state the cost per acre to complete the project. A bid form is attached to this prospectus for your convenience. Preferred bid delivery is by email (.pdf file) to [postfire@honeylakevalleyrcd.us](mailto:postfire@honeylakevalleyrcd.us). Please confirm that your bid has been received either prior to or after transmission. If you need any clarification, please contact Catherine Wooster at 530-260-6642. HLVRCD reserves the right to reject any or all bids for any reason whatsoever.

**Landowners:** Project work is to be completed on lands owned by Kay White

**Project Permit Requirements:** Because the contractor is required to remove forest products, a Notices of Timber Operations has been filed the Landowner's Registered Professional Forester (RPF) with CALFIRE using an exemption from a Timber Harvest Plan. The California Forest Practice Rules shall govern such operations for utilization of forest products, and a Licensed Timber Operator's license Class A shall be required. Standard Best Management Practices established in the CA Forest Practice Rules will govern all operations.

**Treatment Area Designation:** The RPF has identified all treatment areas on the ground. Each treatment area is flagged with surveyor's ribbon.

Color codes and significance are as follows:

Red "Property Boundary"-

Pink "Harvest Boundary"

Blue and White striped "WLPZ"

**Forest Manager:** Eric Wertz, an independent consulting forester and RPF No. 2854, represents the landowner. Should you have any questions, please contact him at 530-356-5643.

**Contract:** Following bid acceptance, a Logging Contract will be finalized with individual contracts for each ownership. Basic contractual obligations will follow the draft contract which will be provided at the Contractor's Tour, via email, and is included with the bid documents. The contract shall terminate no later than December 31, 2026.

**Timeline:** The preferred date for project work to begin is no later than June 15, 2026 and work must be completed by September 01, 2026.

**Other Important Contract Provisions :**

- The acreage identified is only an estimate of the gross area including roads and open areas, and all bidders must make their own assessment as to whether it is accurate or not based upon ground inspections.
- You must be able to provide current evidence of Worker's Compensation, Property Damage and Liability Insurance coverage with coverage no less than \$1,000,000 per occurrence, and a total coverage of not less than \$2,000,000 prior to the start of the project.
- You are responsible for carefully reading all information in this Bid Prospectus and accompanying Draft Contract prior to submitting your bid.
- You will be required to comply with all Federal, State and Local laws and regulations including but not limited to any provisions regarding treatment of and payment of employees and/or subcontractors.
- This is a non-smoking job site.

- You are required to demonstrate that your equipment has been sanitized and is weed-free.
- Multiple factors will be used in selecting the successful bidder including, but not limited to, price, services offered, experience, research with respect to past projects and knowledge of your work by other foresters/landowners, potential start date, capacity to complete the job timely, past violations of the Forest Practices Act. etc. The lowest price bid will not necessarily be the selected Contractor.

**Project Map:**

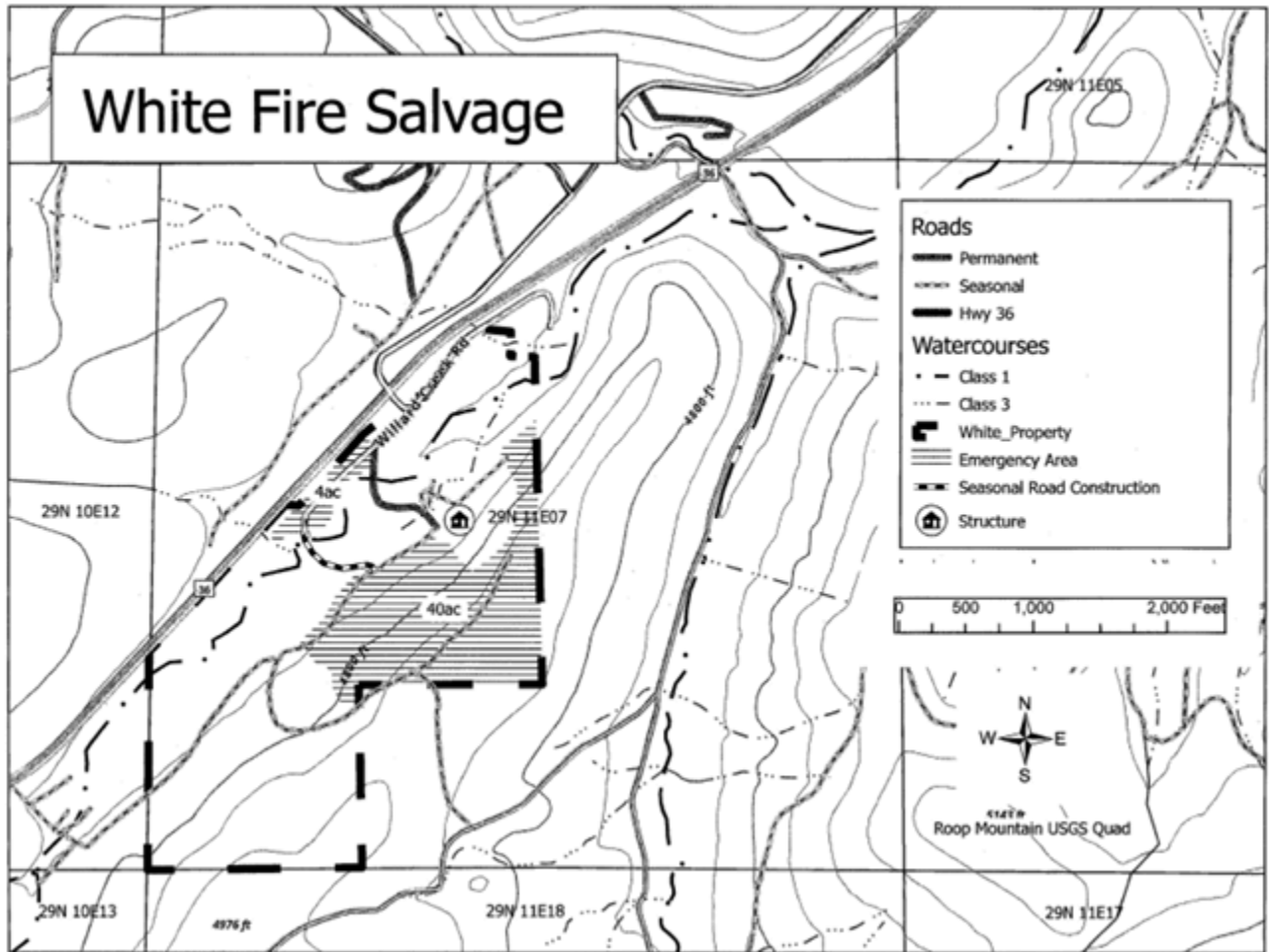

Please fill out this form and submit to Catherine Wooster, [postfire@honeylakevalleyrcd.us](mailto:postfire@honeylakevalleyrcd.us), 520-260-6642, or mail to 1516 Main Street Susanville, CA, 89509.

Deadline: April 30th, 2026

**PROJECT:** Post Fire Restoration Project

**OWNER(S):** Kay White

This bid is from

Company Name: \_\_\_\_\_

Address: \_\_\_\_\_

Contact Information: \_\_\_\_\_

LTO #: \_\_\_\_\_

1. Mechanically thin & deliver chips (+/- 40 acres) Price per acre \$ \_\_\_\_\_  
(Price per acre should incorporate all costs to complete the project)(No guarantee is made by landowner or its RPF of the acreage listed above, nor the volume of biomass material)
2. Earliest possible start date: \_\_\_\_\_
3. Last 3 job sites & landowners: (include name, phone number, acres,)
4. Provide the name, addresses and telephone numbers of subcontractors that you will be using and identify what they will be providing (you do not need to identify trucks and trailers that will be used for hauling chips):
5. List the make, model, and year of equipment that you own that will be used on the jobs
6. List the make, model and year of all equipment that your subcontractors own that will be used on the jobs. Also identify which subcontractor owns the equipment (You do not need to identify trucks and trailers that will be used for hauling chips):

7. Provide name, address and telephone number of your insurance carrier and the amounts and types of coverage that you carry:

8. Other pertinent information bidder may wish to provide:

Signature: \_\_\_\_\_

Date: \_\_\_\_\_

Printed Name: \_\_\_\_\_

Title: \_\_\_\_\_